

IS-8 Bronze Vertical Lift Check Valve Screwed, IS : 778 Class-1 (ISI Marked)

Product Description

HSN 84813000

Product : 'SANT' Bronze Vertical Lift Check Valve
Product Standard : IS-778
Pressure/Class/Rating : Class-1
Body Material cum Standard : GM (IS:318 Gr.LTB2)
Type of Seat : Integral seat
Trim : Cu-Alloy
End Details : Screwed female threads to IS:554 Parallel

Testing & Certification

Body Test Pressure : 1.5 MPa Hyd.
Seat Test Pressure : 1.0 MPa Hyd.
Max Working Temperature: 45°C

Our Works' Test Certificate is furnished with every supply.

Application

Water	Oil
-------	-----



Materials of Construction

Components	Materials	Specifications
Body & Valve Disc	Gun Metal / Leaded Tin Bronze	IS:318 Gr.LTB2
Nut & Washer	Forged Brass	IS:6912 FLB
Spring	Phosphor Bronze	—

Dimensions (in mm)

Nominal Size	Nominal Size (Inches)	F
15	1/2	65±1.5
20	3/4	70±1.5
25	1	75±1.5
32	1.1/4	85±1.5
40	1.1/2	95±1.5
50	2	110±1.5
65	2.1/2	130±1.5
80	3	145±1.5
100	4	190±1.5

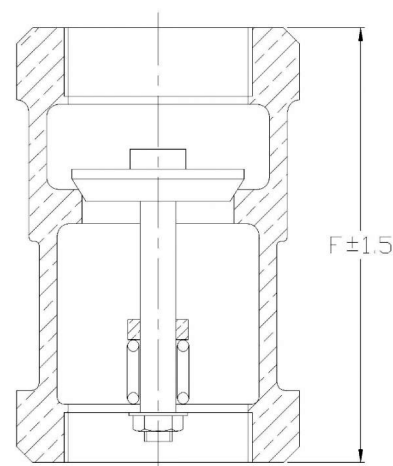

Notes

- Product images are for illustration purposes only. Actual product may vary.
- Actual dimensions may change over time, due to continual design improvements. Please confirm before placing order.